

PLANS FOR PROPOSED ADDITION TO EXISTING GARAGE

PROPERTY LOCATION:
COWLITZ COUNTY
RYDERWOOD 1 SUBDIVISION
BLOCK 6, LOT 5
#WN0320069

LIST OF DRAWINGS:

- SHEET 1 - TITLE PAGE
- SHEET 2 - PLOT PLAN
- SHEET 3 - PLAN VIEW
- SHEET 4 - CROSS-SECTION VIEW
- SHEET 5 - ROOF TRUSS
- SHEET 6 - CEMENT PAD
- SHEET 7 - ELECTRICAL
- SHEET 8 - WALL DETAIL N/S
- SHEET 9 - WALL DETAIL E/W

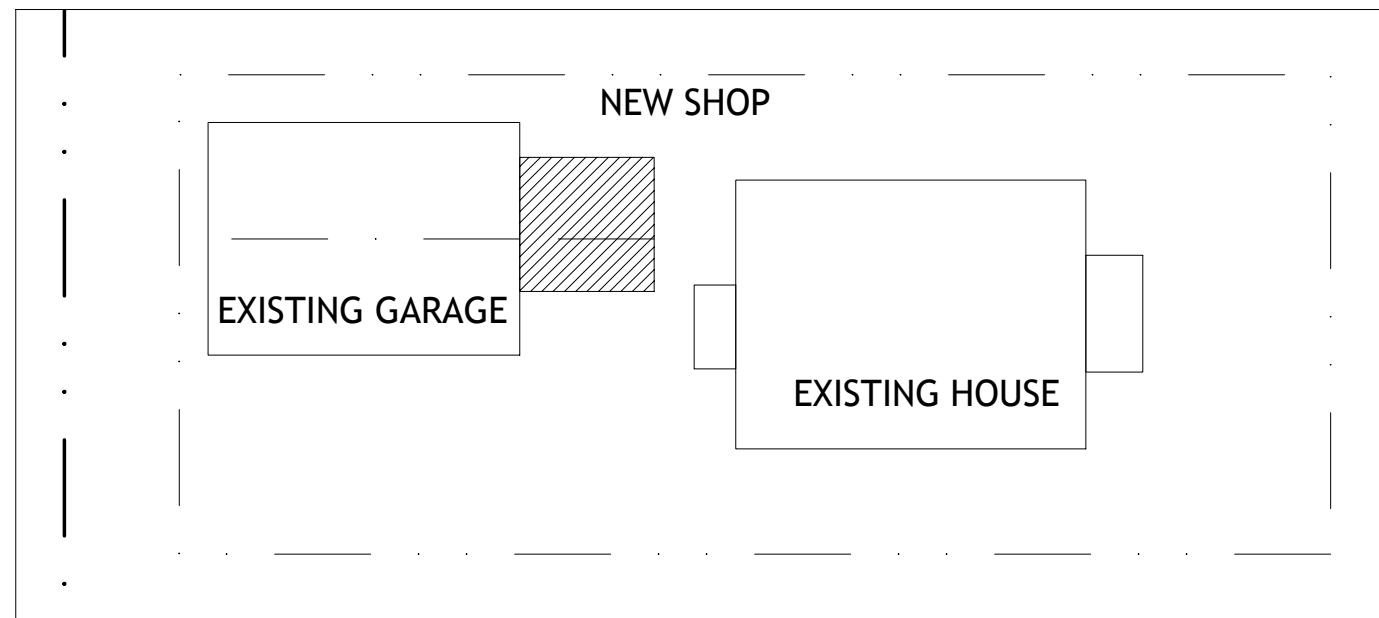

GARAGE SHOP ADDITION	
TITLE SHEET	
507 Monroe St., Ryderwood, Wa Howard Replogle	
Not to Scale	Sheet 01 Rev. D